

6-FM-55Ah

Valve-regulated Lead Acid Battery Specification

Features

- Maintenance free
- Safety and no leakage
- Excellent recharge and discharge performance
- Low self-discharge rate
- Adapt to high or low temperature
- Good deep discharge performance
- Longer cycle life



Specification

| | |
|------------------------------------|--|
| Rated Voltage | 12V |
| Numbers of cells | 6 Cells |
| Capacity | 55Ah@10hr-rate to 1.80V per cell @25°C |
| Weight | 17.7kg |
| Internal Resistance | Approx. 7.5 mΩ |
| Terminal | F6 |
| Max. Discharge Current | 660A(5s) |
| Short Circuit Current | 2750A |
| Max. Charging Current | 13.75A |
| Reference Capacity | C10 55.0AH C3 43.7AH C1 35.5AH |
| Design Life | 10~15 years |
| Float Charging Voltage | 13.6 V~13.8 V @ 25°C Temperature Compensation: -20mV/°C/Cell |
| Cycle Use Voltage | 14.4 V~14.9 V @ 25°C Temperature Compensation: -30mV/°C/Cell |
| Operating Temperature Range | Discharge: -15°C~50°C Charge: 0°C~40°C Storage: -15°C~40°C |
| Normal Operating Temperature Range | 25°C±5°C |
| Self Discharge | Less than 3% at 25°C per month |
| Container Material | A.B.S. UL94-HB, UL94-V0 Optional. |

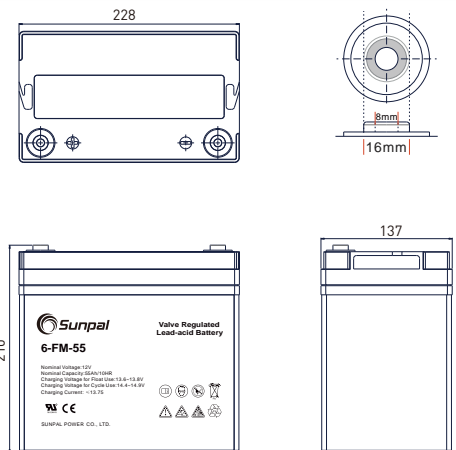

| | |
|--------------|-----------------------|
| Length | 228±2mm (8.98 inches) |
| Width | 137±1mm (5.39 inches) |
| Height | 210±1mm (8.27 inches) |
| Total Height | 230±1mm (9.06 inches) |

Constant Current Discharge Characteristics: A[25°C]

| F.V/Time | 10min | 20min | 30min | 45min | 1h | 2h | 3h | 5h | 8h | 10h | 20h |
|------------|--------|-------|-------|-------|-------|-------|-------|-------|------|------|------|
| 1.80V/cell | 102.90 | 70.00 | 42.60 | 39.40 | 30.80 | 18.60 | 14.30 | 9.40 | 6.61 | 5.50 | 2.95 |
| 1.75V/cell | 113.10 | 75.30 | 50.30 | 40.80 | 32.20 | 19.30 | 14.60 | 9.65 | 6.73 | 5.56 | 2.98 |
| 1.70V/cell | 123.20 | 79.10 | 52.20 | 42.50 | 33.20 | 20.10 | 15.00 | 9.89 | 6.82 | 5.61 | 3.03 |
| 1.65V/cell | 133.00 | 84.10 | 54.30 | 43.50 | 34.30 | 20.60 | 15.60 | 10.20 | 6.93 | 5.73 | 3.07 |
| 1.60V/cell | 144.40 | 89.50 | 60.50 | 45.40 | 35.50 | 21.30 | 16.10 | 10.50 | 6.99 | 5.79 | 3.09 |

Constant Power Discharge Characteristics: WPC[25°C]

| F.V/Time | 10min | 20min | 30min | 45min | 1h | 2h | 3h | 5h | 8h | 10h | 20h |
|------------|--------|--------|--------|-------|-------|-------|-------|-------|-------|-------|------|
| 1.80V/cell | 189.40 | 131.40 | 95.40 | 75.50 | 59.40 | 36.10 | 27.80 | 18.40 | 13.10 | 10.90 | 5.89 |
| 1.75V/cell | 205.60 | 140.10 | 98.60 | 78.00 | 61.90 | 37.30 | 28.30 | 18.90 | 13.30 | 11.00 | 5.94 |
| 1.70V/cell | 220.90 | 146.40 | 102.20 | 80.90 | 63.70 | 38.70 | 29.00 | 19.30 | 13.50 | 11.10 | 6.04 |
| 1.65V/cell | 236.70 | 154.80 | 107.30 | 82.60 | 65.60 | 39.60 | 30.10 | 19.80 | 13.60 | 11.30 | 6.11 |
| 1.60V/cell | 252.60 | 163.20 | 112.20 | 85.30 | 67.40 | 40.70 | 30.90 | 20.30 | 13.80 | 11.40 | 6.14 |

6-FM-55Ah

Valve-regulated Lead Acid Battery Specification

Charge Characteristics for Float Use @ 25°C/77°F

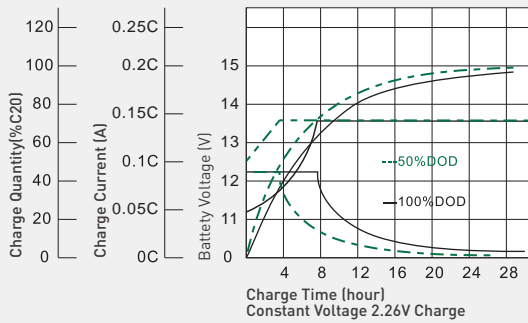

Discharge Characteristics at Various Rates @ 25°C/77°F

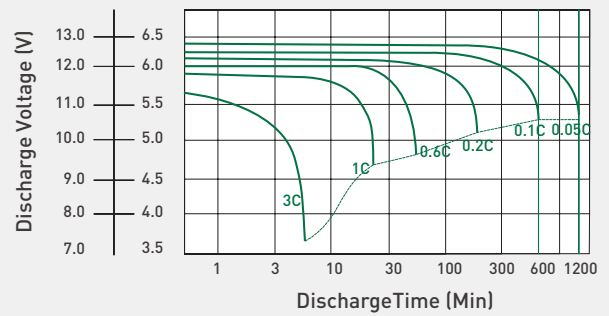

Cycle Life in Relation to Depth of Discharge

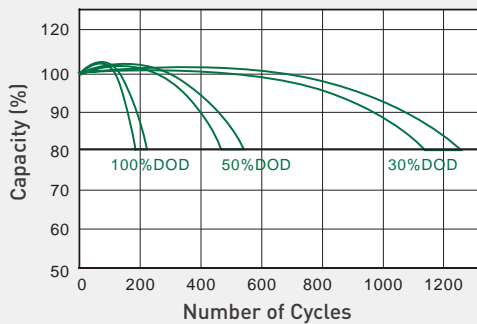

Float Service Life

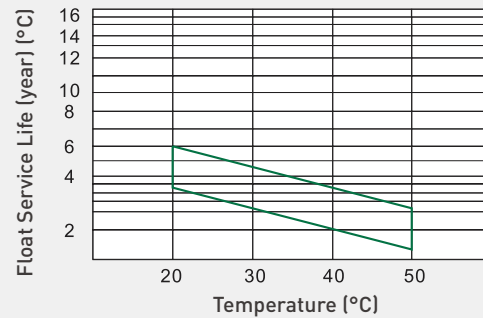

Temperature and Valid Capacity

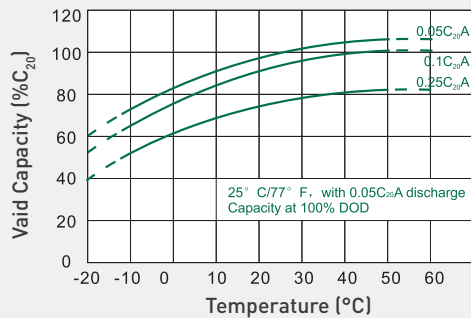

Self Discharge Characteristics

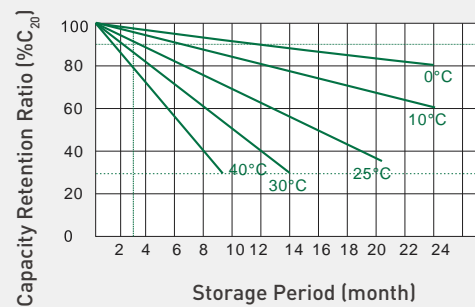

Capacity and Open Circuit Voltage

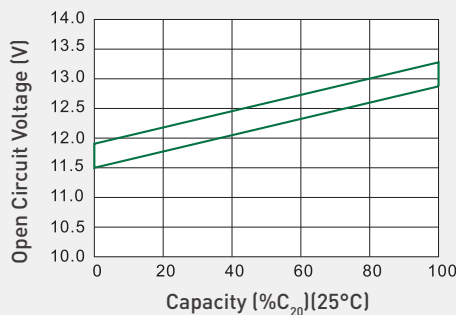

Relationship between Charging Voltage and Temperature

